



Date: October 22, 2018

New York State Department of Environmental Conservation
1 Hunters Point Plaza
47-40 21st Street – 4th floor
Long Island City, NY 11101

ATTN: Denise Harrington Grattan, Environmental Analyst II, DEP

Re: **Response to NOIA Application ID: 2-6105-00889/00001**

Dear Ms. Grattan:

Sharps Compliance, Inc. (“Sharps”), is providing the following information requested in your October 12, 2018 email regarding Sharps’ proposed Transfer Station (Project) requesting to address the following comments:

For ease of reference, each comment from the NOIA is presented below in *italics*, followed by Sharps’ response.

1. *The materials management unit has recently been made aware that the proposed Sharps Compliance location has installed a “Modified HVAC System”. This modification needs to be identified and incorporated into the application that is currently under review. Therefore, please provide the following information:*
 - a. *A figure that identifies the location of the HVAC System;*
 - b. *Manufacture specifications for the HVAC System; and*
 - c. *Maintenance schedule for the HVAC System*

Also, include the above items in the table of contents.

Sharps Response: The proposed Sharps Transfer Station has installed a modified HVAC system consisting of two (2) fans (one (1) CANARM HVAC Model No. AX30-2 and one (1) LFI Axial Fans Model No. P20-1RS9M115). Drawing No. C-01 has been revised to show the locations of the modified HVAC system fans (see Attachment G). Manufacturer’s literature including a maintenance program are provided in Attachment H of this Addendum to the June 19, 2018 revised Engineering Report. The tasks listed in the maintenance program (periodic cleaning; check and tighten all nuts, bolts, set screws; and, check for damage or worn parts (signs of corrosion) and refinish/replace) will be conducted on a monthly basis to ensure proper operation and efficiency of the HVAC system. A statement from Sharps indicating that the newly installed HVAC system will be operated at all times during facility operations and maintained per manufacturer’s specifications/maintenance program is also provided in Attachment H. A revised Table of Contents identifying each attachment with a summary description of the contents has been included in the addendum binder (see attached). These revisions / additions to the Addendum to the June 19, 2018 revised Engineering Report are reflected in the Table of Contents.

2. *To the herein-requested revision to the August 21, 2018 addendum to the Revised June 19, 2018 engineering report, please append a dated cover letter which lists the above comment and specifies how the comment is addressed. Identify any changes made to the revised addendum other than including the above requested items and unless otherwise specified all pages, sections, drawings, appendices, and tables cited in this notice refer to the Sharps Compliance August 21, 2018 addendum, as prepared and sealed by Hong Sima, Ph.D., P.E., to the revised June 19, 2018 engineering report.*

Sharps Response: The herein-requested revisions to the August 21, 2018 addendum for the revised June 16, 2018 Engineering Report is being submitted with this Response to NOIA comment cover letter dated October 22, 2018. This Response to NOIA comment cover letter specifies how each NYSDEC comment has been addressed. Note, all pages, sections, drawings, appendices, and tables cited in this NOIA comment cover letter refer to the Sharps Compliance August 21, 2018 addendum, as prepared and sealed by Hong Sima, Ph.D., P.E., to the revised June 19, 2018 Engineering Report.

The changes identified in the following table labelled “Tracked Changes to the revised June 19, 2018 Engineering Report” include corrections and additions to reflect those changes made to the revised June 19, 2018 Engineering Report are provided in the following table:

Tracked Changes to the Revised June 19, 2018 Engineering Report

Engineering Report Section / Appendix	Revision(s)	NYSDEC’s NOIA Attachment
Appendix I	<ul style="list-style-type: none"> • Updated unauthorized waste narrative language; • Included destination information for unauthorized wastes (radioactive, hazardous and solid wastes); and, • Included a current copy of the authorization required to operate each destination facility for radioactive, hazardous and solid wastes provided as Attachments 3, 4 and 5 (respectively) to Appendix I. 	Attachment A
N/A	<ul style="list-style-type: none"> • Hong Sima, Ph.D., P.E. Cover Letter (July 31, 2018), which was included in the July 31, 2018 submission as Attachment B, has been included in this resubmission, per NYSDEC request in the September 10, 2018 NOIA. 	Attachment B
Appendix E	<ul style="list-style-type: none"> • Updated facility operator's information (Section 5); and, • Updated certification block (Section 14). 	Attachment C
Appendix F	<ul style="list-style-type: none"> • Section A. Project and Sponsor Information (p. 1): <ul style="list-style-type: none"> ○ Text to be corrected: “713-443-3539”, “aaladwani@sharpsinc.com” 	Attachment D

<p>Appendix F (cont.)</p>	<ul style="list-style-type: none"> ○ Corrected Text: “713-660-3544”, “cknisley@sharpsinc.com”, respectively ● Section B. Government Approvals, Subsection g. state agencies (p. 2): <ul style="list-style-type: none"> ○ Text to be corrected: “NYS Department of Environmental Conversation and Type of Permit” ○ Correct Text: “NYS Department of Environmental Conservation, RMW Transfer Station permit” ● Section E.1. Land uses on and surrounding the project site, Subsection d. Facilities serving children, the elderly or the disabled within 1,500 feet (p. 10): <ul style="list-style-type: none"> ○ Checked http://maps.nyc.gov/doitt/nycitymap/ for any relevant facilities of concern within a radius of 1,500 feet, and change “No” to “Yes” on check boxes ○ Insert “Public School 202 and Friends of Crown Heights 17” ● Section E.1. Land uses on and surrounding the project site, Subsection h. contamination history (p. 10): <ul style="list-style-type: none"> ○ Text to be corrected: “Appendix J Section F” ○ Correct text: “Appendix F, Section F” ● E.2. Natural Resources on or near Project Site, Subsection g. Geologic features (p.11): <ul style="list-style-type: none"> ○ Delete “see attached response” ● E.2. Natural Resources on or near Project Site, Subsection l. Sole Source Aquifer (p.11): <ul style="list-style-type: none"> ○ Add text: “See Appendix F Section F, additional information #3” ● E.2. Natural Resources on or near Project Site, Subsection o. endangered species (p. 12): <ul style="list-style-type: none"> ○ Text to be corrected: “Appendix J Section F” ○ Correct text: “Appendix F, Section F” ● G. Verification (p. 13): <ul style="list-style-type: none"> ○ Text to be corrected: "Al Aladwani" (printed and signature), “07/31/2017”, “V.P. of Quality” ○ Correct text: “Curtis Knisley” (printed and signature), “08/21/2018”, “Director Quality & Safety”, respectively 	<p>Attachment D</p>
<p>Appendix G</p>	<ul style="list-style-type: none"> ● Updated signature block. 	<p>Attachment E</p>

N/A	<ul style="list-style-type: none">Hong Sima, Ph.D., P.E. Cover Letter (August 21, 2018), which was included in the August 21, 2018 submission, has been included in this resubmission for completeness.	Attachment F
Drawing No. C-01	<ul style="list-style-type: none">Installation locations of the modified HVAC system fans have been identified on the Site Plan.	Attachment G
N/A	<ul style="list-style-type: none">Modified HVAC system manufacturer's literature with maintenance program and a statement of compliance with manufacturer's specifications is included.	Attachment H

3. *Submit two hard copies directly to Regional Permit Administrator along with an electronic copy. The electronic version of the revised addendum should be in a searchable OCR-PDF format and on a CD or similar media. For those documents prepared by a professional engineer, appropriate portions of the document must display the engineer's seal and signature.*

Sharps Response: Two (2) hardcopies of this Response to the October 12, 2018 NOIA and associated material are being sent directly to the Regional Permit Administrator along with an electronic copy. The electronic version of this NOIA response and addendum materials is a searchable OCR-PDF format, provided on a CD. Documents which have been prepared by a professional engineer display the engineer's seal and signature (where appropriate).

If you have any questions or would like to discuss the application, please feel free to contact me at 713- 443-3539.

Sincerely,

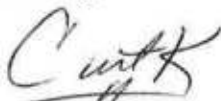

Curtis Knisley
Director Quality & Safety

cc: Hong Sima, Ph.D., P.E.
Karen Meara, Esq.
NYSDEC, Region 2, Regional Permit Administrator

Enclosures: As stated

TABLE OF CONTENTS

Attachment A	Addendum to Sharps Compliance, Inc. Engineering Report for Medical Waste Transfer Station (Revised August 2, 2018), Appendix I – Destination Facility Information
Attachment B	Hong Sima, Ph.D., P.E. Cover Letter (July 31, 2018)
Attachment C	Addendum to Sharps Compliance, Inc. Engineering Report for Medical Waste Transfer Station (Revised August 20, 2018), Appendix E – Application for Solid Waste Management Facility Permit Form
Attachment D	Addendum to Sharps Compliance, Inc. Engineering Report for Medical Waste Transfer Station (Revised August 21, 2018), Appendix F – Environmental Assessment Report and Responses
Attachment E	Addendum to Sharps Compliance, Inc. Engineering Report for Medical Waste Transfer Station (Revised July 31, 2018), Appendix G – Permission to Inspect Property
Attachment F	Hong Sima, Ph.D., P.E. Cover Letter (August 21, 2018)
Attachment G	Addendum to Sharps Compliance, Inc. Engineering Report for Medical Waste Transfer Station (Revised October 22, 2018), Drawing C-01 – Site Plan
Attachment H	Modified HVAC System Manufacturer’s Literature and Maintenance Program (October 22, 2018)

ATTACHMENT G

**ADDENDUM TO
SHARPS COMPLIANCE, INC.
ENGINEERING REPORT FOR REGULATED MEDICAL
WASTE TRANSFER STATION
(REVISED OCTOBER 22, 2018)**

DRAWING C-01 – SITE PLAN



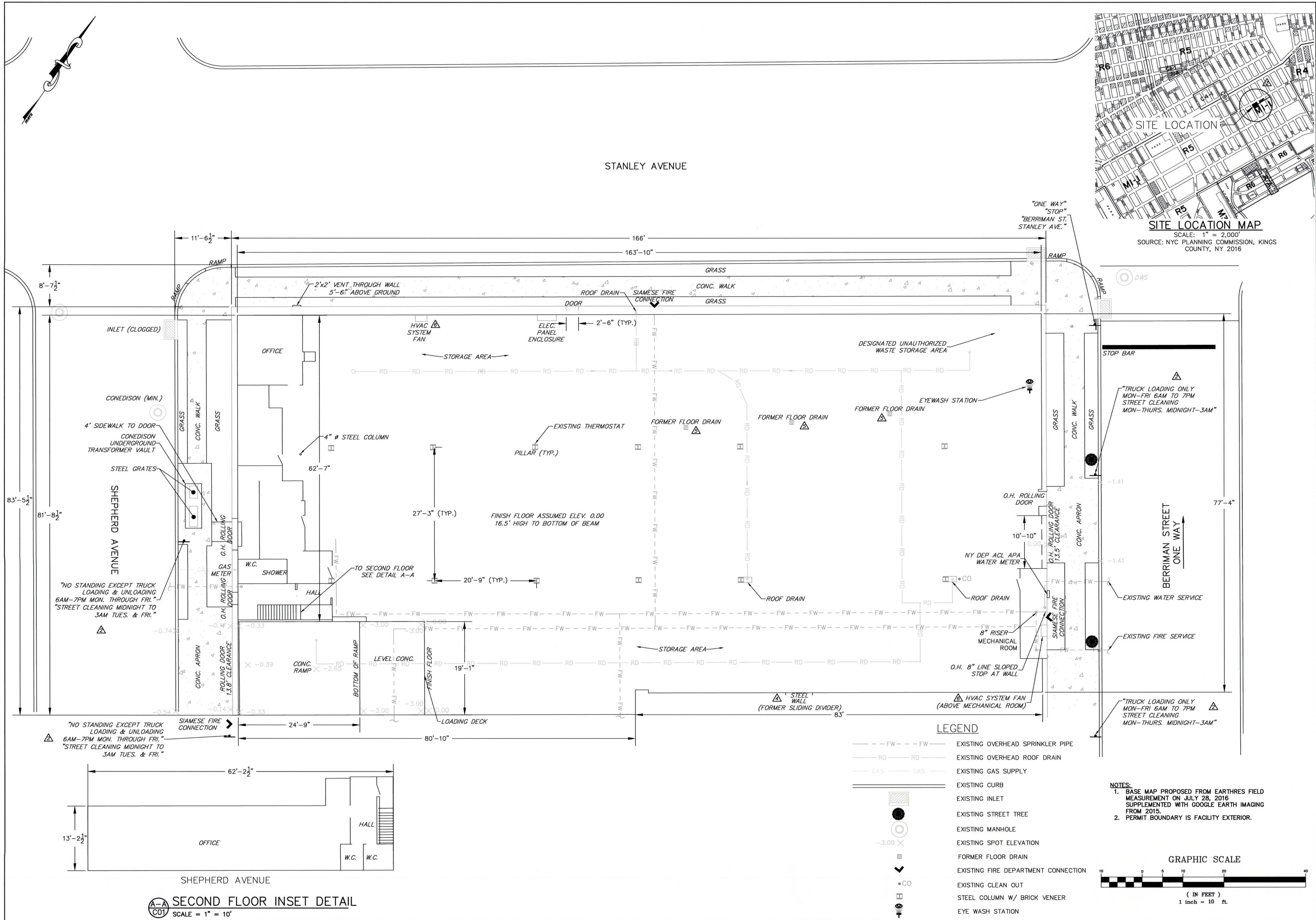

NO.	DATE	BY	REVISIONS
10/22/18	SP		ADDED HVAC SYSTEM FAN LOCATIONS
6/19/18	SP		REVISED FORMER FLOOR DRAIN LABELING
5/1/18	SP		REVISED SLIDING DOOR LABELING
2/5/18	SP		ADDED 800' PERIMETER (360.16(G)(2))
2/5/18	SP		REVISED OPERATING HOURS
9/12/17	JUB		REVISED PER NYSDEC COMMENTS



APPROVED BY: **SHARPS Compliance, Inc.**

PREPARED FOR: **SHARPS Compliance, Inc.**

PREPARED BY: **EARTHRES ENGINEERING FOR SUCCESS™**
 HEADQUARTERS PHILADELPHIA REGION
 P.O. Box 46
 8937 Oak Ridge
 Piquette, PA 15847
 REGIONAL OFFICE
 SPECIAL OFFICE
 8000 Coates Farm Drive
 Morgantown, WV 26505
 www.earthres.com

SITE PLAN TRANSFER STATION
 SHARPS COMPLIANCE, INC.
 803 SHEPHERD AVENUE
 BROOKLYN, NEW YORK 11208

CHECKED BY: **JUB**
 DATE: **09-13-16**
 PROJECT NO.: **151015.003**
 DRAWING NUMBER: **C-01**
 SHEET 1 OF 2

SECOND FLOOR INSET DETAIL
 SCALE = 1" = 10'

LEGEND

---	FW	---	FW	EXISTING OVERHEAD SPRINKLER PIPE
---	RD	---	RD	EXISTING OVERHEAD ROOF DRAIN
---	GAS	---	GAS	EXISTING GAS SUPPLY
---		---		EXISTING CURB
---		---		EXISTING INLET
---		---		EXISTING STREET TREE
---		---		EXISTING MANHOLE
---		---		EXISTING SPOT ELEVATION
---		---		FORMER FLOOR DRAIN
---		---		EXISTING FIRE DEPARTMENT CONNECTION
---		---		EXISTING CLEAN OUT
---		---		STEEL COLUMN W/ BRICK VENEER
---		---		EYE WASH STATION

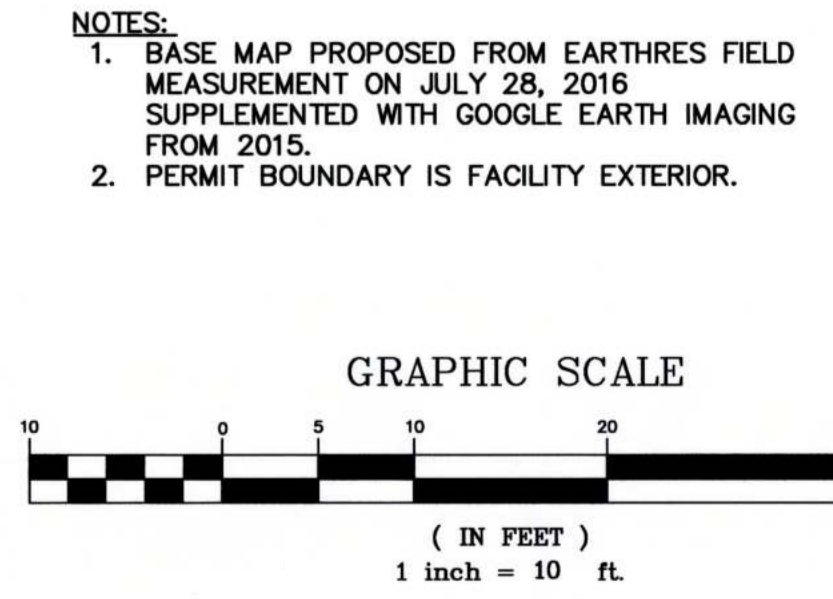

ATTACHMENT H

**MODIFIED HVAC SYSTEM MANUFACTURER'S
LITERATURE AND MAINTENANCE PROGRAM
(OCTOBER 22, 2018)**





AX - SHUTTER MOUNTED FANS

Designed for Industrial, Commercial & Farming applications.



AX SERIES MOTOR



FEATURES

- Sturdily constructed from all-aluminum extrusions.
- 8" - 24" models have heavy wire chrome plated OSHA guards on intake side of fan.
- 30", 36" & 42" models have grey powder coated guards.
- Totally enclosed air over motor with overload protection.



DIMENSIONS

MODEL	A	B	C	D	
				AX	AX-4~
AX08	14 3/4"	11 3/4"	5"	7"	-
AX10	14 3/4"	11 3/4"	5"	7"	-
AX12	16 3/4"	13 3/4"	5"	11"	13 3/4"
AX14	18 3/4"	15 3/4"	5"	11"	13 3/4"
AX16	20 3/4"	17 3/4"	5"	11"	13 3/4"
AX18	22 3/4"	19 3/4"	5"	12"	14"
AX20	24 3/4"	21 3/4"	5"	12"	14"
AX24	28 3/4"	25 3/4"	5"	12"	13 3/4"
AX30	35 1/4"	32 3/4"	5"	13"	-
AX36	41 1/4"	38 3/4"	5"	12"	-
AX42	47 3/4"	44 3/4"	5"	11"	-

~ Explosion Proof Motor, 50 Hz or 3 phase

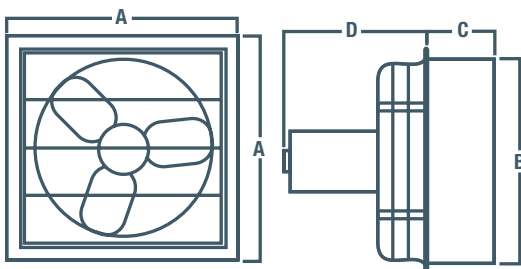

The AX series exhaust fan is a sturdily constructed, direct drive, horizontal discharge fan that is typically used for general ventilation of factories, garages, warehouses and other industrial or commercial buildings. The AX fans are available in multiple single-speed variations as well as two-speed and variable speed models.

The AX series housings are constructed of heavy duty aluminum with built in shutters that automatically open when the fan starts and gravity closes when the fan stops.

Some models now available with optional DC volt motor. Call for details.



EXPLOSION PROOF MOTOR

SPECIFICATIONS

SINGLE PHASE	THREE PHASE	BLADE DIAMETER	RPM	HP (SINGLE PHASE)	VOLTAGE (SINGLE PHASE)	AMPS (FLA) (SINGLE PHASE)	WEIGHT (LBS)	dB(A) @5 ft	CFM @ STATIC PRESSURE				FRAMING DIMENSIONS
									0.00"	0.10"	0.125"	0.25"	
SINGLE SPEED - VARIABLE SPEED FANS													
AX12-1V	AX12-1*	12"	1700	1/3	115/230	5.0/2.5	26	63	1650	1560	1525	1400	14" X 14"
AX12-1VHE	-	12"	1450	1/15	115	1.0	22	60	1350	1290	1275	1150	14" X 14"
AX14-1V	AX14-1*	14"	1700	1/3	115/230	5.0/2.5	29	67	2170	2030	1950	1900	16" X 16"
AX14-1VHE	-	14"	1450	1/15	115	1.0	25	64	1600	1525	1500	1300	16" X 16"
AX16-1V	AX16-1*	16"	1700	1/3	115/230	5.0/2.5	30	68	2570	2470	2410	2260	18" X 18"
AX16-1VHE	-	16"	1450	1/15	115	1.0	26	63	1850	1750	1700	1550	18" X 18"
AX18-1V	AX18-1*	18"	1700	1/3	115/230	3.8/1.9	36	71	3150	3000	2900	2575	20" X 20"
AX20-1V	AX20-1*	20"	1700	1/3	115/230	3.8/1.9	39	77	3620	3420	3340	3120	22" X 22"
AX24-1V	--	24"	1100	1/3	115/230	4.4/2.2	43	72	5500	5400	5310	5100	26" X 26"
--	AX24-1*	24"	1100	1/3	--	--	43	77	5500	5400	5310	5100	26" X 26"
SINGLE SPEED FANS													
AX12-2	--	12"	1625	1/4	115	1.8	27	63	1640	1540	1510	1390	14" X 14"
AX14-2	--	14"	1625	1/4	115	1.8	30	67	2170	2070	2030	1860	16" X 16"
AX16-2	--	16"	1625	1/4	115	1.8	31	68	2370	2270	2210	2060	18" X 18"
AX18-2	--	18"	1625	1/3	115	4.0	37	73	3200	3090	3040	2920	20" X 20"
AX20-2	--	20"	1625	1/3	115	4.0	39	77	3420	3220	3170	2920	22" X 22"
AX24-2	--	24"	1100	1/3	115	5.4	45	70	5000	4500	4300	3600	26" X 26"
AX30-2	--	30"	1100	1/3	115/230	4.4/2.2	72	82	8000	7000	6000	5000	33" X 33"
AX36-7	AX36-7M**	36"	850	1/2	115/230	6.6/3.3	88	72	10000	8500	8000	6200	39" X 39"
AX42-7	--	42"	850	1	230	5.5	122	84	14900	13550	13210	10800	45" X 45"
TWO SPEED FANS													
AX08-3	--	8"	1600/1300	1/20	115	1.7	14	48	360/300	270/150	230/110	--	12" X 12"
AX10-3	--	10"	1600/1300	1/20	115	1.7	14	56	690/580	590/460	570/390	--	12" X 12"
AX12-3	--	12"	1725/1140	1/4	115	3.4	27	64	1670/1100	1600/950	1575/900	1450/625	14" X 14"
AX14-3	--	14"	1725/1140	1/4	115	3.4	31	67	2190/1440	2080/1325	2000/1300	1950/850	16" X 16"
AX16-3	--	16"	1725/1140	1/4	115	3.4	34	69	2580/1770	2480/1620	2430/1560	2270/1020	18" X 18"
AX18-3	--	18"	1725/1140	1/3	115	5.3/2.9	38	74	3200/2310	3050/2030	2950/1960	2625/1750	20" X 20"
AX20-3	--	20"	1725/1140	1/3	115	5.3/2.9	41	77	3640/2420	3440/2270	3360/2210	3140/1890	22" X 22"
SINGLE SPEED EXPLOSION PROOF FANS (Explosion Proof Motors are DIVISION 1 - CLASS 1 - GROUP C & D and CLASS 2 - GROUP F & G)													
Class I, Group C - Atmospheres containing ethyl ether, ethylene, gases or vapors of equivalent hazard.													
Class I, Group D - Atmospheres such as acetone, ammonia, benzene, butane, cyclopropane, ethanol, gasoline, hexane, methane, natural gas, naphtha, propane, or gases or vapors of equivalent hazard.													
Class II Group F - Atmospheres containing carbonaceous dust, including carbon black, charcoal, coal, or coke dusts that have more than 8% total entrapped volatiles, or dusts that have been sensitized by other materials so that they present an explosion hazard.													
Class II Group G - Atmospheres containing combustible dusts not included in group E or F, including flour, grain, wood, plastic and chemicals.													
AX12-4	AX12-4*	12"	1725	1/3	115/208-230	6.6/3.1-3.3	49	63	1670	1600	1575	1450	14" X 14"
AX14-4	AX14-4*	14"	1725	1/3	115/208-230	6.6/3.1-3.3	49	67	2190	2080	2000	1950	16" X 16"
AX16-4	AX16-4*	16"	1725	1/3	115/208-230	6.6/3.1-3.3	51	68	2580	2480	2430	2270	18" X 18"
AX18-4	AX18-4*	18"	1725	1/3	115/208-230	6.6/3.1-3.3	56	73	3200	3050	2950	2625	20" X 20"
AX20-4	AX20-4*	20"	1725	1/3	115/208-230	6.6/3.1-3.3	57	77	3640	3440	3360	3140	22" X 22"
AX24-4	AX24-4*	24"	1725	1/3	115/208-230	6.6/3.1-3.3	57	77	5520	5410	5330	5130	26" X 26"

For three phase motors, substitute "**M**" with "M" for 230/460 volt or "P" for 575 volt
 **NOTE: AX36-7M is only available in 208-230/460 volt for three phase applications
 Other voltages in single or three phase are available. 50HZ voltages are available. Consult factory.

ACCESSORIES

- Speed controls
- Thermostats
- Front guard
- Weather hoods

For a complete listing on all available accessories, see page C15.
 For a complete listing of all available hoods, see page C11.
 For all available control options, see Controls & Thermostats tab.



P12-1R FAN SHOWN

P - SERIES SUPPLY FANS

Designed for Industrial & Commercial Supply applications.



P12-1RS9M1115 FAN SHOWN COMPLETE WITH SLEEVE AND MOTORIZED DAMPER.

FEATURES

- Fully assembled.
- Sturdily constructed direct drive, horizontal fan.
- Durable powder coated finish.
- Heavy duty OSHA motor mount/guard is standard.
- Totally enclosed air over motor with overload protection.



Non-stock, made-to-order products are non-returnable and cannot be cancelled.

DIMENSIONS

MODEL	A X A SQUARE	B	C c/c
P12-1R	17 1/4"	11"	16"
P14-1R	19 1/4"	11"	18"
P16-1R	21 1/4"	11"	20"
P18-1R	23 1/4"	12"	22"
P20-1R	25 1/4"	12"	24"
P24-1R	29 1/4"	12"	28"

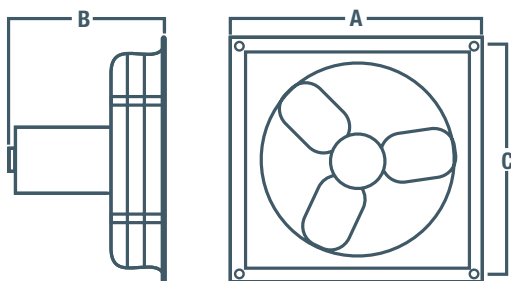

SPECIFICATIONS

MODEL	BLADE DIAMETER	RPM	HP	VOLTAGE	AMPS (FLA)	WEIGHT (LBS)	CFM @ STATIC PRESSURE			
							0.00"	0.10"	0.125"	0.25"
P SERIES SUPPLY FAN										
P12-1R	12"	1700	1/3	115/230	5.0/2.5	26	1450	1400	1370	1260
P14-1R	14"	1700	1/3	115/230	5.0/2.5	29	1950	1825	1750	1700
P16-1R	16"	1700	1/3	115/230	5.0/2.5	30	2310	2200	2150	2030
P18-1R	18"	1700	1/3	115/230	3.8/1.9	36	2835	2700	2600	2315
P20-1R	20"	1700	1/3	115/230	3.8/1.9	39	3250	3075	3000	2800
P24-1R	24"	1100	1/3	115/230	6.4/3.2	43	4040	3928	3848	3520

P SERIES SUPPLY FAN

 Complete with 9" sleeve and 120 Volt motorized damper (specs are for fan motor only and not damper motor)
 For exhaust models, replace "1R" in the model name with "1V".

P12-1RS9M1115	12"	1700	1/3	115/230	5.0/2.5	45	1450	1400	1370	1260
P14-1RS9M1115	14"	1700	1/3	115/230	5.0/2.5	50	1950	1825	1750	1700
P16-1RS9M1115	16"	1700	1/3	115/230	5.0/2.5	54	2310	2200	2150	2030
P18-1RS9M1115	18"	1700	1/3	115/230	3.8/1.9	60	2835	2700	2600	2315
P20-1RS9M1115	20"	1700	1/3	115/230	3.8/1.9	66	3250	3075	3000	2800
P24-1RS9M1115	24"	1100	1/3	115/230	4.4/2.2	73	4040	3928	3848	3520

ACCESSORIES

- Thermostats
- Front guard
- Weather hoods

For a complete listing on all available accessories, see page C15.
 For a complete listing of all available hoods, see page C11.
 For all available control options, see Controls & Thermostats tab.



Date: October 22, 2018

New York State Department of Environmental Conservation
1 Hunters Point Plaza
47-40 21st Street – 4th floor
Long Island City, NY 11101

ATTN: Denise Harrington Grattan, Environmental Analyst II, DEP

Re: Modified HVAC System Operation & Maintenance

Dear Ms. Grattan:

The proposed Sharps Compliance, Inc. (“Sharps”) Transfer Station has installed a modified HVAC system consisting of two (2) fans (one (1) CANARM HVAC Model No. AX30-2 and one (1) LFI Axial Fans Model No. P20-1RS9M115). The newly installed HVAC system will be operated at all times during facility operations and maintained per manufacturer’s specifications/maintenance program (see attached). The tasks listed in the maintenance program (periodic cleaning; check and tighten all nuts, bolts, set screws; and, check for damage or worn parts (signs of corrosion) and refinish/replace) will be conducted on a monthly basis to ensure proper operation and efficiency of the HVAC system.

If you have any questions or would like to discuss the HVAC system, please feel free to contact me at 713-432-0300.

Sincerely,

A handwritten signature in black ink, appearing to read "D. Tusa", with a long horizontal flourish extending to the right.

David P. Tusa
Chief Executive Officer & President

cc: Hong Sima, Ph.D., P.E.
Karen Meara, Esq.
NYSDEC, Region 2, Regional Permit Administrator

Enclosures: As stated



INSTALLATION FOR AX & P WALL EXHAUST FANS

WALL OPENING SIZES

The Canarm/LFI P series fans can be mounted either horizontally or vertically. AX-series fans are to be mounted horizontally only. When mounting the AX series fan, the wall opening should be ½” larger than the shutter box size. The P series wall opening should be 1-3/4” larger than the fan blade diameter. Both the AX & P series fans are meant to be installed on the inside of an outside wall; the fan should be centered over the opening and lagged to the wall.

PRE-INSTALLATION CHECK

Prior to installation of a fan, please check carefully for any damage. If damage is found, do not install. Check and tighten all nuts, bolts, set screws, etc., which may have loosened during shipping and handling. Before connecting to the power source, check the motor nameplate, and the power supply, to ensure that they are both rated for the same power supply. Make sure the propeller turns freely without striking the fan frame or any other objects.

AIR EXHAUST AND SUPPLY

The AX series fan is to be used as an exhaust fan only (not suitable for supply air).

The P series fan is primarily used as an exhaust fan, however, the single speed (1700 rpm models) can be set up to act as a supply fan. This is accomplished by mounting the blade opposite to the exhaust configuration and reversing the rotation of the motor. When used as a supply fan, in conjunction with a shutter, the shutter must be motorized. To attach the shutter to the fan, a wall sleeve may be required. For wall opening sizes on P series with sleeve refer to catalogue sheet.

VARIABLE SPEED FANS

Canarm/LFI AX-1V, AX-1HE and P-1V, P-1VHE Series are variable speed or single speed. These are the only models that can be used with a speed controller. When using the AX-1V or AX-1VHE Series with a variable speed controller care should be taken not to reduce the speed to low. If the airflow is reduced significantly the shutters may not open properly. This may cause motor problems. For variable operation, a suitable variable speed control is required.



OPERATION AND MAINTENANCE FOR AX & P SERIES WALL FANS

REGULAR MAINTENANCE

Fans should periodically be cleaned to remove accumulated dust, dirt, or any other foreign matter. If rust or corrosion is found, the affected area or part should be cleaned and refinished or replaced.

Periodically - check and tighten all nuts, bolts, set screws, etc.

Periodically - check for damage or worn parts and replace.

**** CAUTION ****

All local, provincial or national codes should be checked. Ensure that all wiring, guarding and fan applications comply with all applicable codes. The proper type and class of fan and motor must be used in Explosive/Hazardous Applications.

WARRANTY AND LIMITATION OF LIABILITY

If the products sold hereunder are defective at the time of delivery in material or workmanship and written notice is given to Seller within one year after shipment, Seller, at its option will repair or replace the products, give Buyer an equitable credit, or refund the purchase price for such products determined by Seller to be defective, provided that the products shall not been altered or repaired after shipment to Buyer by anyone except Sellers authorized employees. ***SELLER'S TOTAL RESPONSIBILITY SHALL NOT EXCEED THE SALES PRICE OF THE DEFECTIVE PRODUCTS.***

TRANSPORTATION TO RETURN DEFECTIVE PRODUCTS IS TO BE PREPAID. If Buyer fails to give such notice within one year after shipment, any claims for breach of warranty by Seller shall be barred. Products manufactured by others but furnished by Seller are limited to original manufacturer's warranty. Canarm/LFI Limited assumes no liability for resultant damages, labour and service charges of any kind arising from the use of its products. On equipment furnished by Canarm/LFI Limited but manufactured by others, such as motors, the warranty will be honored by the manufacturer hereof.



CANARM LTD.

2157 Parkedale Avenue, Brockville, Ontario K6V 5V6 Canada

Ph: (613) 342-5424

Fax: (613) 342-8437

www.canarm.com